

## FEATURES

Thank you for purchasing the TECSUN S-2000. Its features and capabilities are shown below:

- MW 522-1620 kHz (9k Tuning Step)  
520-1710 kHz (10k Tuning Step)
- LW 100-519 kHz
- SW 1711-29999 kHz
- AIR 118-137 MHz
- FM 87-108 MHz  
88-108 MHz (America)  
76-108 MHz (Japan)
- FM stereo via Earphones or Headphones.
- Dual Conversion for LW, MW & SW
- Single Side Band (SSB) with USB & LSB
- Auto/Manual Frequency Tuning or Station Memory Tuning or Direct Frequency Key-in Function
- Auto Tuning Storage (ATS) Function for FM / MW & LW (5s Pre-listening while Auto Tuning)
- 1000 Station Memories (100 each for FM, SW, SSB & Air Band; 50 each for MW & LW; 500 for Mixed Band)
- 24 Hrs Clock & Dual Alarm Clock Function (Alarm by either Radio or Buzzer)
- Sleep Timer Function
- Extra Long Telescopic Antenna for FM, SW, Air Band.
- 360 Degrees Rotating MW Antenna
- External or Internal FM / MW Antenna Switch
- Antenna Attenuation to Enhance Reception.
- Squelch Control for Quality FM and Air Band Listening.
- Wide / Narrow Bandwidth Selection
- RF Gain Control Knob
- 455 kHz IF Output Jack for DIY (Synchronous Detection, DSP Demodulator, DRM Converter)
- High Quality Built-in 4" Speaker with Excellent Sound Effect.
- Line in Socket (can be used as speaker for MP3)
- Line out Socket (radio broadcast can be transferred to other device).
- Power Sources: 4D Alkaline Batteries  
220V AC Power  
6V DC Jack (Adaptor is not included)
- Dimensions: 372 x 183 x 153 mm (W x H x D)
- Weight: 5.95 lbs (2.7 kg)

## SPECIFICATIONS

<b>Frequency range</b> LW MW SW AIR FM	100-519kHz 522-1620kHz ----- system code "09" 520-1710 kHz (America) -- system code "10" 1711-29999kHz 118-137MHz 87-108MHz 76-108MHz (Japan) 87.5-108MHz (America)
<b>Sensitivity</b> LW (S/N=26dB) MW (S/N=26dB) SW (S/N=26dB) SSB (S/N=10dB) AIR (S/N=10dB) FM (S/N=30dB)	Less than 3mV/m Less than 0.35mV/m Less than 18 $\mu$ V Less than 1 $\mu$ V Less than 5 $\mu$ V Less than 3 $\mu$ V
<b>Selectivity</b> AM	Wideband $\pm$ 10kHz, Greater than 40dB Narrowband $\pm$ 5kHz, Greater than 60dB
<b>FM Stereo crosstalk</b>	Better than 30dB
<b>Signal to Noise Ratio</b> MW SW FM	Greater than 45dB Greater than 50dB Greater than 60dB
<b>IF Frequency</b>	SSB, AM: 1st IF : 55.845MHz 2nd IF: 455kHz FM: 1st IF: 10.7MHz (Single Conversion)
<b>Image Rejection</b> MW/LW/SW AIR FM	55.845MHz: Greater than 90dB 455kHz: Greater than 80dB Greater than 90dB Greater than 60dB
<b>IF Rejection</b> AM FM	55.845MHz: Greater than 60dB 455kHz: Greater than 60dB 10.7MHz: Greater than 100dB

<b>AGC Performance</b>	AGC range: Wider than 80dB Threshold : 12 $\mu$ V	
<b>RF GAIN</b>	20dB	
<b>Antenna Attenuation</b>	Three levels: 0dB, -10dB, -20dB	
<b>Internal Antennal</b>	<ul style="list-style-type: none"> <li>● 1200mm telescoping whip (for use on FM, AIR, SW and SSB bands)</li> <li>● IFerrite rod antenna <math>\phi</math> 10X120mm(HQ) (for use from 100kHz through 1800kHz)</li> </ul>	
<b>External Antenna Input</b>	SW	50 $\Omega$ (BNC type), 500 $\Omega$
	FM AIR	50 $\Omega$ (BNC type)
<b>IF Output</b>	IF: 455kHz Signals output greater than 60mV when input greater than 3 $\mu$ V	
<b>Line Audio Outputs</b>	Stereo left and right 300mV, 4.7k $\Omega$ for each output.	
<b>Earphone Jack</b>	$\phi$ 3.5mm, 8~32 $\Omega$ , stereo type	
<b>Internal Speaker</b>	8 $\Omega$ / 2W, $\phi$ 100mm	
<b>Power supply</b>	Batteries : D size, UM1 (alkaline) x 4 AC ~220V/50Hz (AC power cord included for Asia market)	
<b>DC Jack</b>	DC 6V / 500mA, negative polarity $\oplus$ — $\ominus$ Outside diameter: $\phi$ 5.5mm, Core diameter: $\phi$ 2mm (DC adaptor included for Europe market)	
<b>Current Consumption</b>	Quiescent Current	Standby Current less than 85uA FM less than 70mA MW less than 80mA SW less than 90mA SSB less than 95mA
	Dynamic Current	Rated Current 350mA (Output 650mW, Distortion less than 1%) Maximum Current less than 500mA (Output 1500mW)
<b>Operating Temperature</b>	-5°C to +50°C	
<b>Weight</b>	2.7kg (batteries NOT included)	
<b>Size</b>	372 (W) X 183 (H) X 153 (D) mm (front handle included)	

● TECSUN S-2000 PRODUCT ASSEMBLY DIAGRAM

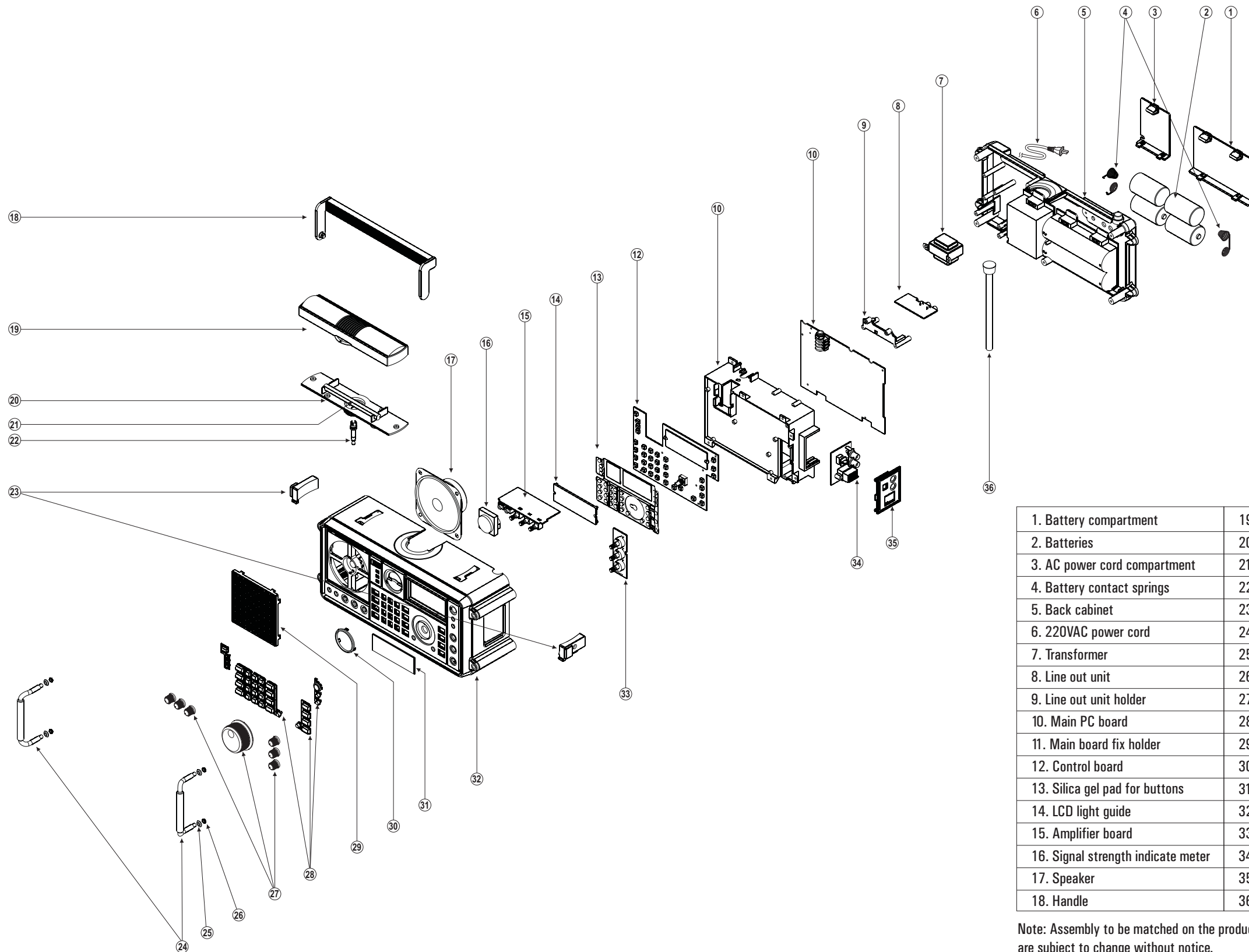

1. Battery compartment	19. AM aerial upper cover
2. Batteries	20. AM aerial lower cover
3. AC power cord compartment	21. Magnetic rod with coil
4. Battery contact springs	22. AM aerial plug
5. Back cabinet	23. Handle fixer
6. 220VAC power cord	24. Handgrip
7. Transformer	25. Handgrip gasket
8. Line out unit	26. Handgrip screw nut
9. Line out unit holder	27. Knobs
10. Main PC board	28. Buttons
11. Main board fix holder	29. Speaker grill
12. Control board	30. Plastic ring for signal meter
13. Silica gel pad for buttons	31. LCD plastic lens
14. LCD light guide	32. Front cabinet
15. Amplifier board	33. Control board
16. Signal strength indicate meter	34. External antenna connect board
17. Speaker	35. Plastic cover
18. Handle	36. Telescopic antenna

Note: Assembly to be matched on the products, color, specifications and data are subject to change without notice.